

Beirut Port 57K

5700K CCT

55353 Lumens

32m pole height

Partner for Contact:

Order No.:

Company:

Customer No.:

Date: 11.12.2014

Operator:

Operator
Telephone
Fax
e-Mail

CREE, INC. FLD-EHO-15--24-D-UL-700-57K (700mA) 60 LED 700mA 4000K 15 DEGREE
EDGE FLOOD FIXTURE / Luminaire Data Sheet**

Luminous emittance 1:

See our luminaire catalog for an image of the luminaire.

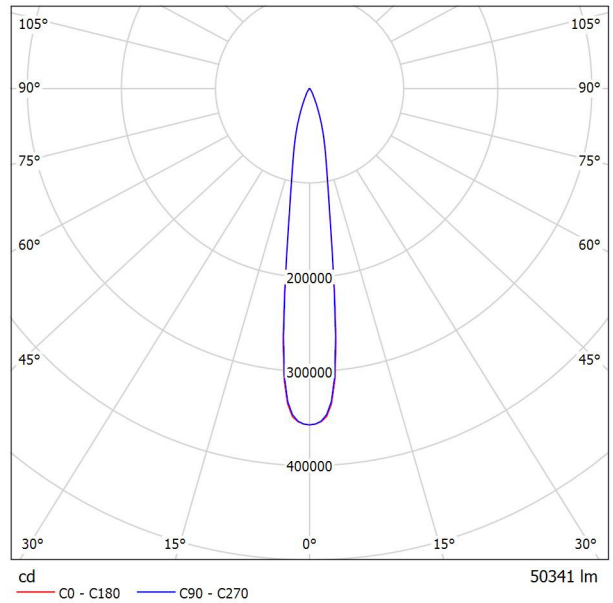

Luminaire classification according to CIE: 100
CIE flux code: 97 99 100 100 100

Luminous emittance 1:

Glare Evaluation According to UGR											
ρ Ceiling	70	70	50	50	30	70	70	50	50	30	
ρ Walls	50	30	50	30	30	50	30	50	30	30	
ρ Floor	20	20	20	20	20	20	20	20	20	20	
Room Size	Viewing direction at right angles to lamp axis					Viewing direction parallel to lamp axis					
X	Y										
2H	2H	17.5	18.2	17.7	18.3	18.5	17.5	18.2	17.8	18.4	18.6
	3H	17.6	18.2	17.9	18.4	18.7	17.6	18.2	17.9	18.5	18.7
	4H	17.6	18.2	17.9	18.4	18.7	17.7	18.2	18.0	18.5	18.7
	6H	17.6	18.2	18.0	18.4	18.7	17.6	18.2	18.0	18.4	18.7
	8H	17.6	18.1	18.0	18.4	18.7	17.6	18.1	18.0	18.4	18.7
4H	12H	17.6	18.1	17.9	18.4	18.7	17.6	18.1	17.9	18.4	18.7
	2H	17.5	18.1	17.8	18.3	18.6	17.5	18.1	17.8	18.4	18.6
	3H	17.7	18.1	18.0	18.4	18.8	17.7	18.2	18.0	18.5	18.8
	4H	17.7	18.1	18.1	18.5	18.8	17.7	18.2	18.1	18.5	18.8
	6H	17.8	18.1	18.2	18.5	18.9	17.8	18.1	18.2	18.5	18.9
8H	8H	17.8	18.1	18.2	18.5	18.9	17.8	18.1	18.2	18.4	18.8
	12H	17.8	18.0	18.2	18.4	18.9	17.7	18.0	18.2	18.4	18.8
	4H	17.7	18.0	18.1	18.4	18.8	17.7	18.0	18.1	18.4	18.8
	6H	17.8	18.0	18.2	18.4	18.9	17.8	18.0	18.2	18.4	18.8
	8H	17.8	18.0	18.3	18.4	18.9	17.8	17.9	18.2	18.4	18.8
12H	12H	17.8	18.0	18.3	18.4	18.9	17.7	17.9	18.2	18.3	18.8
	4H	17.7	17.9	18.1	18.3	18.7	17.7	17.9	18.1	18.3	18.8
	6H	17.8	17.9	18.2	18.4	18.8	17.7	17.9	18.2	18.4	18.8
8H	17.8	17.9	18.3	18.4	18.9	17.7	17.9	18.2	18.3	18.8	
Variation of the observer position for the luminaire distances S											
S = 1.0H	+2.9 / -2.2					+3.0 / -2.4					
S = 1.5H	+5.1 / -3.4					+5.3 / -3.7					
S = 2.0H	+6.9 / -4.5					+7.1 / -4.9					
Standard table	BK01					BK01					
Correction Summand	-0.4					-0.4					
Corrected Glare Indices referring to 50341lm Total Luminous Flux											

Operator
 Telephone
 Fax
 e-Mail

CREE, INC. FLD-EHO-25--24-D-UL-700-40K (700mA) 60 LED 700mA 4000K 25 DEGREE
 EDGE FLOOD FIXTURE / Luminaire Data Sheet**

Luminous emittance 1:

See our luminaire catalog for an image of the luminaire.

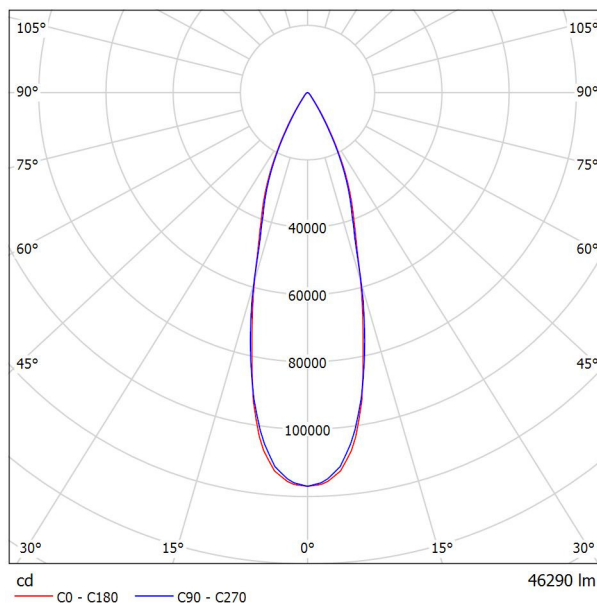

Luminaire classification according to CIE: 100
 CIE flux code: 96 99 100 100 100

Luminous emittance 1:

Glare Evaluation According to UGR											
p Ceiling		70	70	50	50	30	70	70	50	50	30
p Walls		50	30	50	30	30	50	30	50	30	30
p Floor		20	20	20	20	20	20	20	20	20	20
Room Size	X Y	Viewing direction at right angles to lamp axis					Viewing direction parallel to lamp axis				
2H	2H	20.5	21.2	20.8	21.4	21.6	19.9	20.6	20.2	20.8	21.0
	3H	20.6	21.3	20.9	21.5	21.7	20.1	20.7	20.4	20.9	21.2
	4H	20.7	21.2	21.0	21.5	21.8	20.1	20.7	20.4	21.0	21.2
	6H	20.6	21.2	20.9	21.4	21.7	20.1	20.6	20.4	20.9	21.2
	8H	20.6	21.1	20.9	21.4	21.7	20.0	20.6	20.4	20.8	21.1
4H	12H	20.6	21.0	20.9	21.3	21.7	20.0	20.5	20.4	20.8	21.1
	2H	20.5	21.0	20.8	21.3	21.6	19.9	20.5	20.2	20.8	21.0
	3H	20.7	21.2	21.0	21.5	21.8	20.2	20.7	20.5	21.0	21.3
	4H	20.8	21.2	21.1	21.5	21.8	20.2	20.7	20.6	21.0	21.3
	6H	20.7	21.1	21.1	21.4	21.8	20.2	20.6	20.6	20.9	21.3
8H	8H	20.7	21.0	21.1	21.4	21.8	20.2	20.5	20.6	20.9	21.3
	12H	20.7	20.9	21.1	21.3	21.7	20.1	20.4	20.6	20.8	21.2
	4H	20.7	21.0	21.1	21.4	21.8	20.2	20.5	20.6	20.9	21.3
	6H	20.7	20.9	21.1	21.3	21.8	20.2	20.4	20.6	20.8	21.3
	8H	20.7	20.8	21.1	21.3	21.8	20.2	20.3	20.6	20.8	21.2
12H	12H	20.6	20.8	21.1	21.2	21.7	20.1	20.3	20.6	20.7	21.2
	4H	20.7	20.9	21.1	21.3	21.8	20.2	20.4	20.6	20.8	21.3
	6H	20.6	20.8	21.1	21.3	21.7	20.1	20.3	20.6	20.8	21.2
8H	20.6	20.8	21.1	21.2	21.7	20.1	20.3	20.6	20.7	21.2	
Variation of the observer position for the luminaire distances S											
S = 1.0H		+3.9 / -3.0					+3.6 / -2.9				
S = 1.5H		+6.4 / -3.9					+6.1 / -3.8				
S = 2.0H		+8.3 / -4.9					+8.0 / -4.8				
Standard table		BK01					BK01				
Correction Summand		2.6					2.1				
Corrected Glare Indices referring to 46290lm Total Luminous Flux											

Operator
Telephone
Fax
e-Mail

CREE, INC. FLD-EHO-40--24-E-UL-700-57K (700mA) 40 DEG FLOOD OPTIC, 240 LEDS, 5700K / Luminaire Data Sheet**

Luminous emittance 1:

See our luminaire catalog for an image of the luminaire.

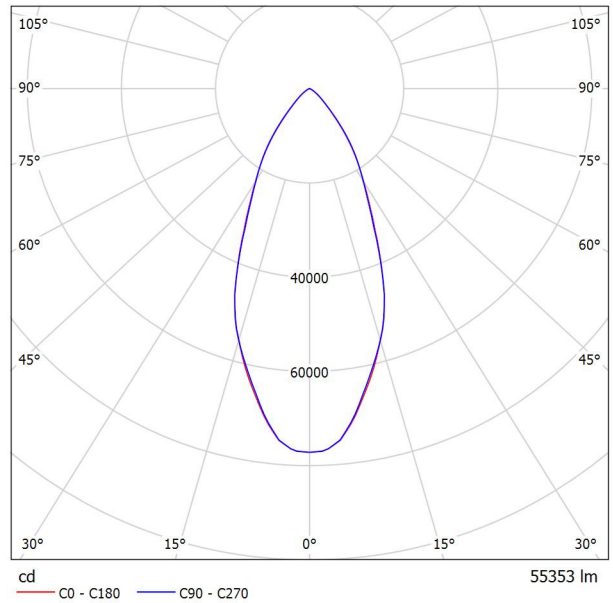

Luminaire classification according to CIE: 100
CIE flux code: 89 99 100 100 100

Luminous emittance 1:

Glare Evaluation According to UGR											
p Ceiling		70	70	50	50	30	70	70	50	50	30
p Walls		50	30	50	30	30	50	30	50	30	30
p Floor		20	20	20	20	20	20	20	20	20	20
Room Size	Viewing direction at right angles to lamp axis	Viewing direction parallel to lamp axis									
X Y											
2H	2H	22.9	23.7	23.2	23.9	24.1	23.0	23.7	23.2	23.9	24.1
	3H	22.9	23.5	23.1	23.8	24.0	22.9	23.6	23.1	23.8	24.0
	4H	22.8	23.4	23.1	23.7	24.0	22.8	23.4	23.1	23.7	24.0
	6H	22.7	23.3	23.1	23.6	23.9	22.7	23.3	23.1	23.6	23.9
	8H	22.7	23.3	23.0	23.6	23.9	22.7	23.3	23.0	23.6	23.9
4H	12H	22.7	23.2	23.0	23.5	23.8	22.7	23.2	23.0	23.5	23.8
	2H	22.8	23.5	23.1	23.7	24.0	22.8	23.5	23.1	23.7	24.0
	3H	22.7	23.3	23.1	23.6	23.9	22.7	23.3	23.1	23.6	23.9
	4H	22.7	23.1	23.1	23.5	23.8	22.7	23.1	23.1	23.5	23.8
	6H	22.6	23.0	23.0	23.4	23.8	22.6	23.0	23.0	23.4	23.8
8H	8H	22.6	22.9	23.0	23.3	23.7	22.6	22.9	23.0	23.3	23.7
	12H	22.5	22.9	23.0	23.3	23.7	22.6	22.9	23.0	23.3	23.7
	4H	22.6	22.9	23.0	23.3	23.7	22.6	22.9	23.0	23.3	23.7
	6H	22.5	22.8	23.0	23.2	23.6	22.5	22.8	23.0	23.2	23.6
	8H	22.5	22.7	22.9	23.1	23.6	22.5	22.7	22.9	23.1	23.6
12H	12H	22.4	22.6	22.9	23.1	23.6	22.4	22.6	22.9	23.1	23.6
	4H	22.5	22.8	23.0	23.2	23.7	22.5	22.8	23.0	23.2	23.7
	6H	22.5	22.7	22.9	23.1	23.6	22.5	22.7	22.9	23.1	23.6
8H	22.4	22.6	22.9	23.1	23.6	22.4	22.6	22.9	23.1	23.6	
Variation of the observer position for the luminaire distances S											
S = 1.0H	+2.8 / -4.9					+2.7 / -5.0					
S = 1.5H	+5.2 / -7.9					+5.2 / -8.3					
S = 2.0H	+7.1 / -10.7					+7.1 / -11.1					
Standard table	BK00					BK00					
Correction Summand	4.4					4.4					
Corrected Glare Indices referring to 55353lm Total Luminous Flux											

Operator
Telephone
Fax
e-Mail

Beirut Port Area / Planning data

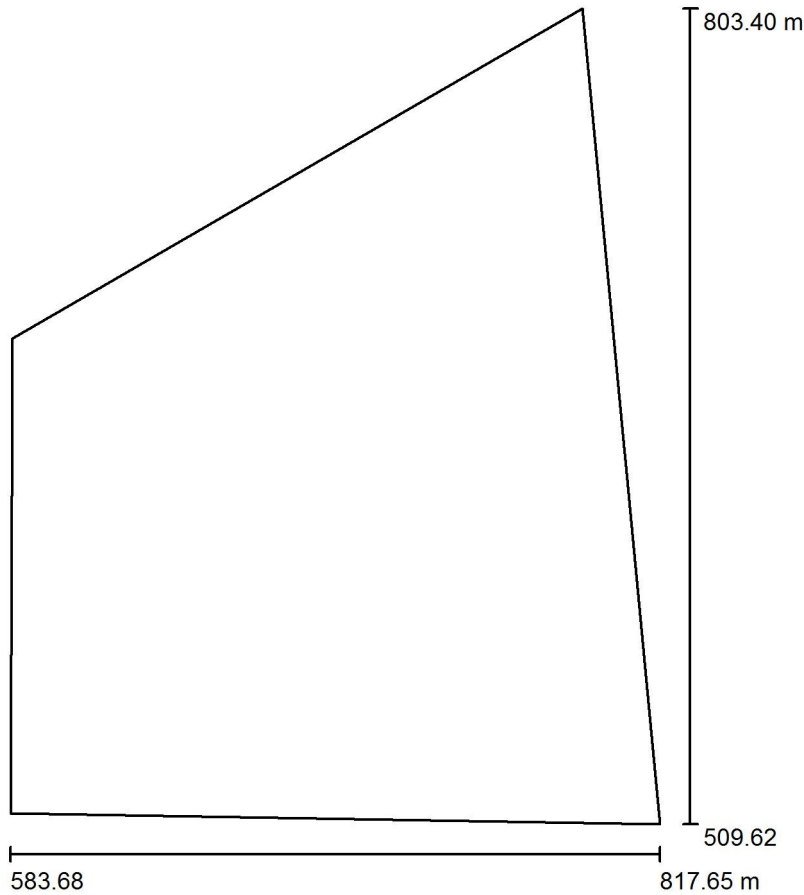

Light loss factor: 0.80, ULR (Upward Light Ratio): 1.5%

Scale 1:2724

Luminaire Parts List

No.	Pieces	Designation (Correction Factor)	Φ (Luminaire) [lm]	Φ (Lamps) [lm]	P [W]
1	4	CREE, INC. FLD-EHO-15-**-24-D-UL-700-57K (700mA) 60 LED 700mA 4000K 15 DEGREE EDGE FLOOD FIXTURE (1.000)	50341	50341	539.0
2	7	CREE, INC. FLD-EHO-25-**-24-D-UL-700-40K (700mA) 60 LED 700mA 4000K 25 DEGREE EDGE FLOOD FIXTURE (1.000)	46290	46290	539.0
3	74	CREE, INC. FLD-EHO-40-**-24-E-UL-700-57K (700mA) 40 DEG FLOOD OPTIC, 240 LEDS, 5700K (1.000)	55353	55353	539.0
Total:			4621503	Total: 4621503	45815.0

Operator
Telephone
Fax
e-Mail

Beirut Port Area / Luminaire parts list

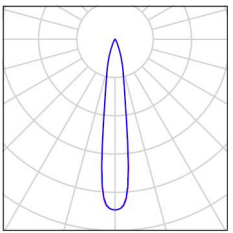
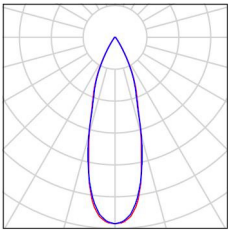
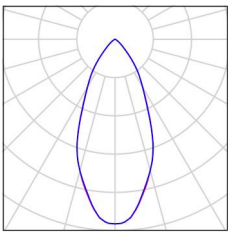
4 Pieces	<p>CREE, INC. FLD-EHO-15-**-24-D-UL-700-57K (700mA) 60 LED 700mA 4000K 15 DEGREE EDGE FLOOD FIXTURE Article No.: FLD-EHO-15-**-24-D-UL-700-57K (700mA) Luminous flux (Luminaire): 50341 lm Luminous flux (Lamps): 50341 lm Luminaire Wattage: 539.0 W Luminaire classification according to CIE: 100 CIE flux code: 97 99 100 100 100 Fitting: 240 x SIXTY WHITE LIGHT EMITTING DIODES (LEDS), VERTICAL BASE-UP (Correction Factor 1.000).</p>	See our luminaire catalog for an image of the luminaire.	
7 Pieces	<p>CREE, INC. FLD-EHO-25-**-24-D-UL-700-40K (700mA) 60 LED 700mA 4000K 25 DEGREE EDGE FLOOD FIXTURE Article No.: FLD-EHO-25-**-24-D-UL-700-40K (700mA) Luminous flux (Luminaire): 46290 lm Luminous flux (Lamps): 46290 lm Luminaire Wattage: 539.0 W Luminaire classification according to CIE: 100 CIE flux code: 96 99 100 100 100 Fitting: 240 x SIXTY WHITE LIGHT EMITTING DIODES (LEDS), VERTICAL BASE-UP (Correction Factor 1.000).</p>	See our luminaire catalog for an image of the luminaire.	
74 Pieces	<p>CREE, INC. FLD-EHO-40-**-24-E-UL-700-57K (700mA) 40 DEG FLOOD OPTIC, 240 LEDES, 5700K Article No.: FLD-EHO-40-**-24-E-UL-700-57K (700mA) Luminous flux (Luminaire): 55353 lm Luminous flux (Lamps): 55353 lm Luminaire Wattage: 539.0 W Luminaire classification according to CIE: 100 CIE flux code: 89 99 100 100 100 Fitting: 240 x TWO HUNDRED FORTY WHITE LIGHT EMITTING DIODES (LEDS), (Correction Factor 1.000).</p>	See our luminaire catalog for an image of the luminaire.	

Operator
Telephone
Fax
e-Mail

Beirut Port Area / Luminaires (layout plan)

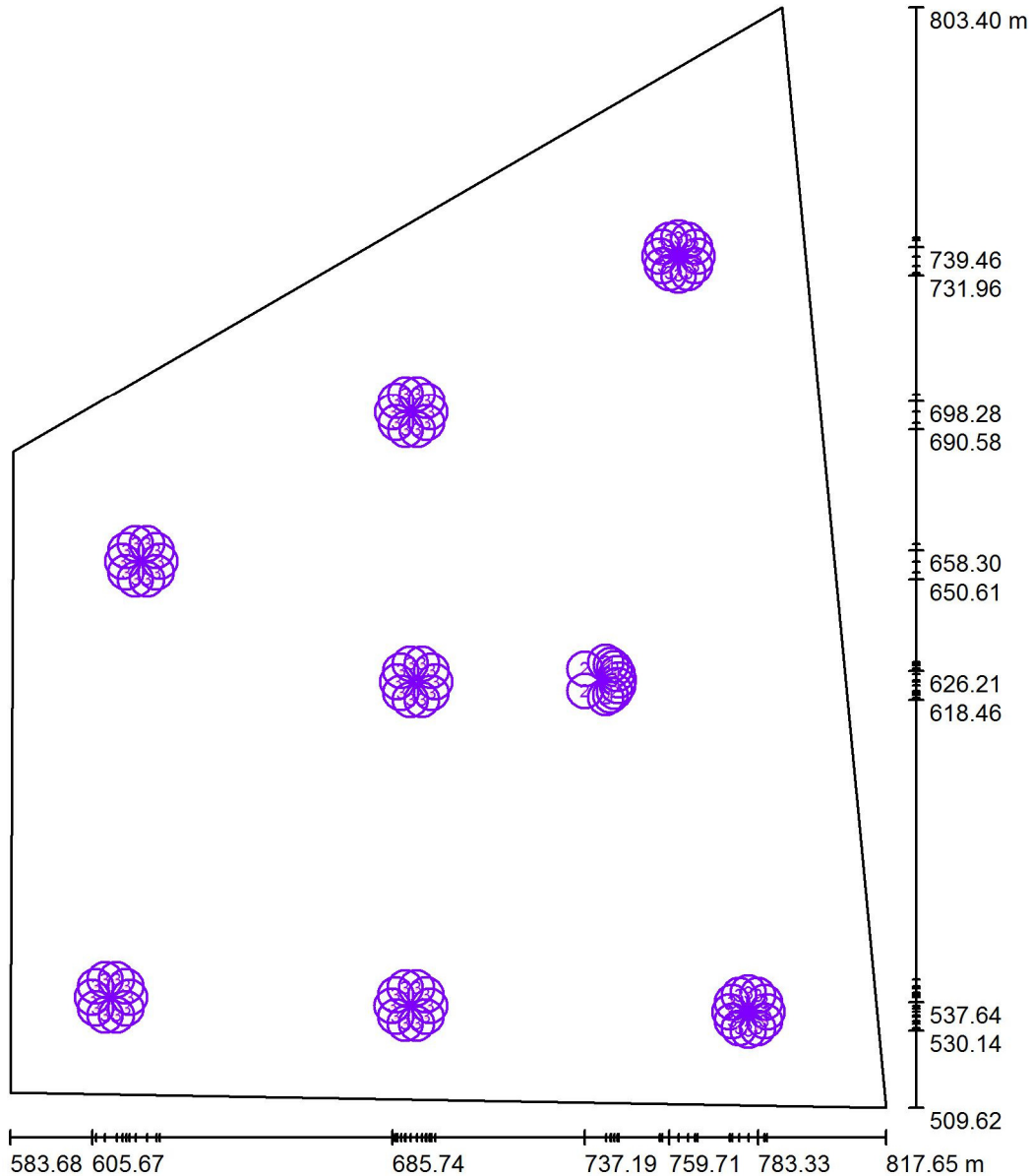

Scale 1 : 1987

Luminaire Parts List

No.	Pieces	Designation
1	4	CREE, INC. FLD-EHO-15-**-24-D-UL-700-57K (700mA) 60 LED 700mA 4000K 15 DEGREE EDGE FLOOD FIXTURE
2	7	CREE, INC. FLD-EHO-25-**-24-D-UL-700-40K (700mA) 60 LED 700mA 4000K 25 DEGREE EDGE FLOOD FIXTURE
3	74	CREE, INC. FLD-EHO-40-**-24-E-UL-700-57K (700mA) 40 DEG FLOOD OPTIC, 240 LEDS, 5700K

Operator
Telephone
Fax
e-Mail

Beirut Port Area / Luminaires (coordinates list)

CREE, INC. FLD-EHO-15-**-24-D-UL-700-57K (700mA) 60 LED 700mA 4000K 15 DEGREE EDGE FLOOD FIXTURE

50341 lm, 539.0 W, 1 x 240 x SIXTY WHITE LIGHT EMITTING DIODES (LEDS), VERTICAL BASE-UP (Correction Factor 1.000).

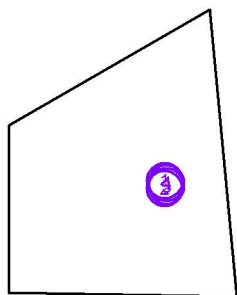

No.	Position [m]			Rotation [°]		
	X	Y	Z	X	Y	Z
1	744.198	627.710	32.000	60.0	-45.0	0.0
2	744.007	619.718	32.000	-60.0	-45.0	0.0
3	745.933	622.286	32.000	-30.0	-60.0	0.0
4	745.852	625.408	32.000	30.0	-60.0	0.0

Operator
Telephone
Fax
e-Mail

Beirut Port Area / Luminaires (coordinates list)

CREE, INC. FLD-EHO-25-**-24-D-UL-700-40K (700mA) 60 LED 700mA 4000K 25 DEGREE EDGE FLOOD FIXTURE

46290 lm, 539.0 W, 1 x 240 x SIXTY WHITE LIGHT EMITTING DIODES (LEDS), VERTICAL BASE-UP (Correction Factor 1.000).

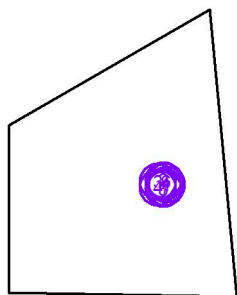

No.	Position [m]			Rotation [°]		
	X	Y	Z	X	Y	Z
1	746.235	623.765	32.000	0.0	-45.0	0.0
2	742.780	628.520	32.000	0.0	-45.0	72.0
3	737.190	626.704	32.000	0.0	-45.0	144.0
4	737.190	620.826	32.000	0.0	-45.0	-144.0
5	742.780	619.010	32.000	0.0	-45.0	-72.0
6	745.107	626.829	32.000	30.0	-45.0	0.0
7	745.103	620.762	32.000	-30.0	-45.0	0.0

Operator
Telephone
Fax
e-Mail

Beirut Port Area / Luminaires (coordinates list)

CREE, INC. FLD-EHO-40-**-24-E-UL-700-57K (700mA) 40 DEG FLOOD OPTIC, 240 LEDS, 5700K

55353 lm, 539.0 W, 1 x 240 x TWO HUNDRED FORTY WHITE LIGHT EMITTING DIODES (LEDS), (Correction Factor 1.000).

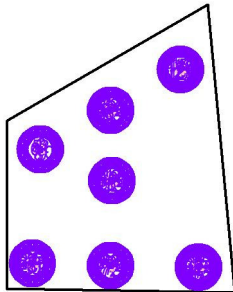

No.	Position [m]			Rotation [°]		
	X	Y	Z	X	Y	Z
1	623.738	655.362	32.000	0.0	-45.0	0.0
2	622.783	658.301	32.000	0.0	-45.0	36.0
3	620.283	660.117	32.000	0.0	-45.0	72.0
4	617.193	660.117	32.000	0.0	-45.0	108.0
5	614.693	658.301	32.000	0.0	-45.0	144.0
6	613.738	655.362	32.000	0.0	-45.0	180.0
7	614.693	652.423	32.000	0.0	-45.0	-144.0
8	617.193	650.606	32.000	0.0	-45.0	-108.0
9	620.283	650.606	32.000	0.0	-45.0	-72.0
10	622.783	652.423	32.000	0.0	-45.0	-36.0
11	767.207	736.959	32.000	0.0	-45.0	0.0
12	766.537	739.459	32.000	0.0	-45.0	30.0
13	764.707	741.289	32.000	0.0	-45.0	60.0
14	762.207	741.959	32.000	0.0	-45.0	90.0
15	759.707	741.289	32.000	0.0	-45.0	120.0
16	757.877	739.459	32.000	0.0	-45.0	150.0
17	757.207	736.959	32.000	0.0	-45.0	180.0
18	757.877	734.459	32.000	0.0	-45.0	-150.0
19	759.707	732.629	32.000	0.0	-45.0	-120.0
20	762.207	731.959	32.000	0.0	-45.0	-90.0
21	764.707	732.629	32.000	0.0	-45.0	-60.0
22	766.537	734.459	32.000	0.0	-45.0	-30.0
23	615.667	538.958	32.000	0.0	-45.0	0.0
24	614.712	541.897	32.000	0.0	-45.0	36.0
25	612.212	543.713	32.000	0.0	-45.0	72.0
26	609.122	543.713	32.000	0.0	-45.0	108.0
27	606.622	541.897	32.000	0.0	-45.0	144.0

Operator
Telephone
Fax
e-Mail

Beirut Port Area / Luminaires (coordinates list)

No.	Position [m]			Rotation [°]		
	X	Y	Z	X	Y	Z
29	606.622	536.019	32.000	0.0	-45.0	-144.0
30	609.122	534.202	32.000	0.0	-45.0	-108.0
31	612.212	534.202	32.000	0.0	-45.0	-72.0
32	614.712	536.019	32.000	0.0	-45.0	-36.0
33	785.826	535.136	32.000	0.0	-45.0	0.0
34	785.156	537.636	32.000	0.0	-45.0	30.0
35	783.326	539.466	32.000	0.0	-45.0	60.0
36	780.826	540.136	32.000	0.0	-45.0	90.0
37	778.326	539.466	32.000	0.0	-45.0	120.0
38	776.496	537.636	32.000	0.0	-45.0	150.0
39	775.826	535.136	32.000	0.0	-45.0	180.0
40	776.496	532.636	32.000	0.0	-45.0	-150.0
41	778.326	530.806	32.000	0.0	-45.0	-120.0
42	780.826	530.136	32.000	0.0	-45.0	-90.0
43	783.326	530.806	32.000	0.0	-45.0	-60.0
44	785.156	532.636	32.000	0.0	-45.0	-30.0
45	697.208	623.251	32.000	0.0	-45.0	0.0
46	696.246	626.212	32.000	0.0	-45.0	36.0
47	693.727	628.042	32.000	0.0	-45.0	72.0
48	690.613	628.042	32.000	0.0	-45.0	108.0
49	688.094	626.212	32.000	0.0	-45.0	144.0
50	687.132	623.251	32.000	0.0	-45.0	180.0
51	688.094	620.290	32.000	0.0	-45.0	-144.0
52	690.613	618.459	32.000	0.0	-45.0	-108.0
53	693.727	618.459	32.000	0.0	-45.0	-72.0
54	696.246	620.290	32.000	0.0	-45.0	-36.0
55	695.856	695.339	32.000	0.0	-45.0	0.0
56	694.901	698.278	32.000	0.0	-45.0	36.0
57	692.401	700.094	32.000	0.0	-45.0	72.0
58	689.311	700.094	32.000	0.0	-45.0	108.0
59	686.811	698.278	32.000	0.0	-45.0	144.0
60	685.856	695.339	32.000	0.0	-45.0	180.0
61	686.811	692.400	32.000	0.0	-45.0	-144.0
62	689.311	690.584	32.000	0.0	-45.0	-108.0
63	692.401	690.584	32.000	0.0	-45.0	-72.0
64	694.901	692.400	32.000	0.0	-45.0	-36.0
65	695.736	536.712	32.000	0.0	-45.0	0.0
66	694.781	539.651	32.000	0.0	-45.0	36.0

Operator
Telephone
Fax
e-Mail

Beirut Port Area / Luminaires (coordinates list)

No.	Position [m]			Rotation [°]		
	X	Y	Z	X	Y	Z
67	692.281	541.467	32.000	0.0	-45.0	72.0
68	689.191	541.467	32.000	0.0	-45.0	108.0
69	686.691	539.651	32.000	0.0	-45.0	144.0
70	685.736	536.712	32.000	0.0	-45.0	180.0
71	686.691	533.773	32.000	0.0	-45.0	-144.0
72	689.191	531.957	32.000	0.0	-45.0	-108.0
73	692.281	531.957	32.000	0.0	-45.0	-72.0
74	694.781	533.773	32.000	0.0	-45.0	-36.0

Operator
Telephone
Fax
e-Mail

Beirut Port Area / 3D Rendering

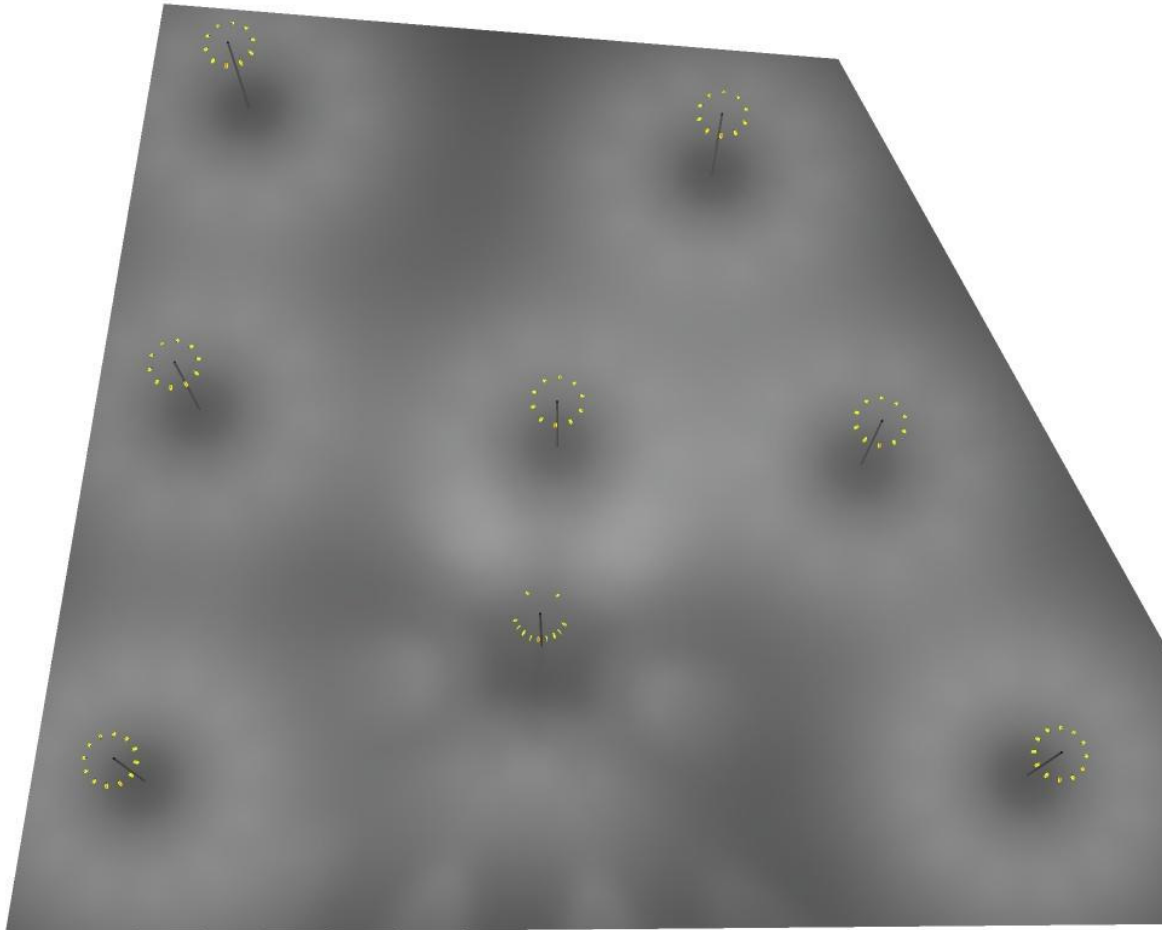

Operator
Telephone
Fax
e-Mail

Beirut Port Area / False Color Rendering

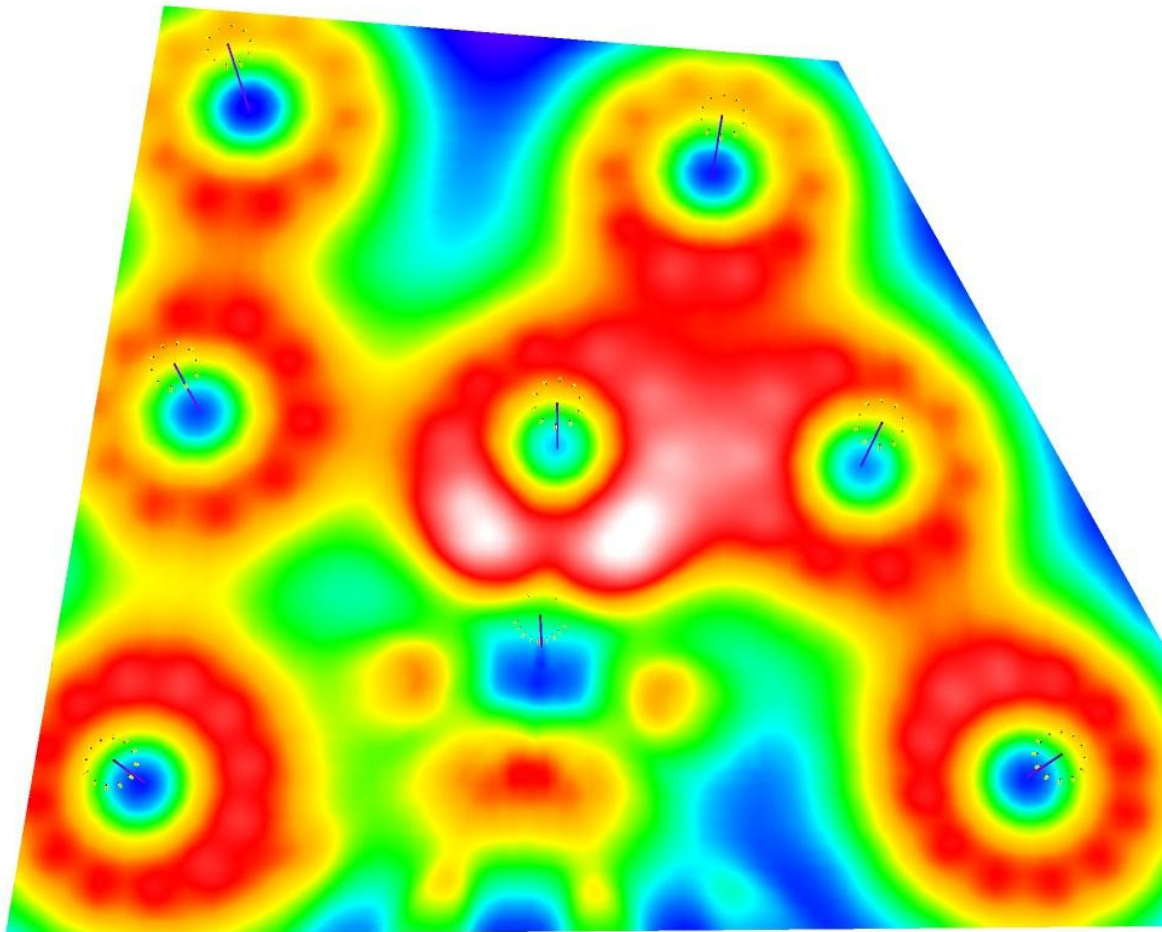

0 10.01 20.02 30.03 40 50 60 70 100 lx

Operator
 Telephone
 Fax
 e-Mail

Beirut Port Area / Beirut Port Area / Surface 1 / Isolines (E)

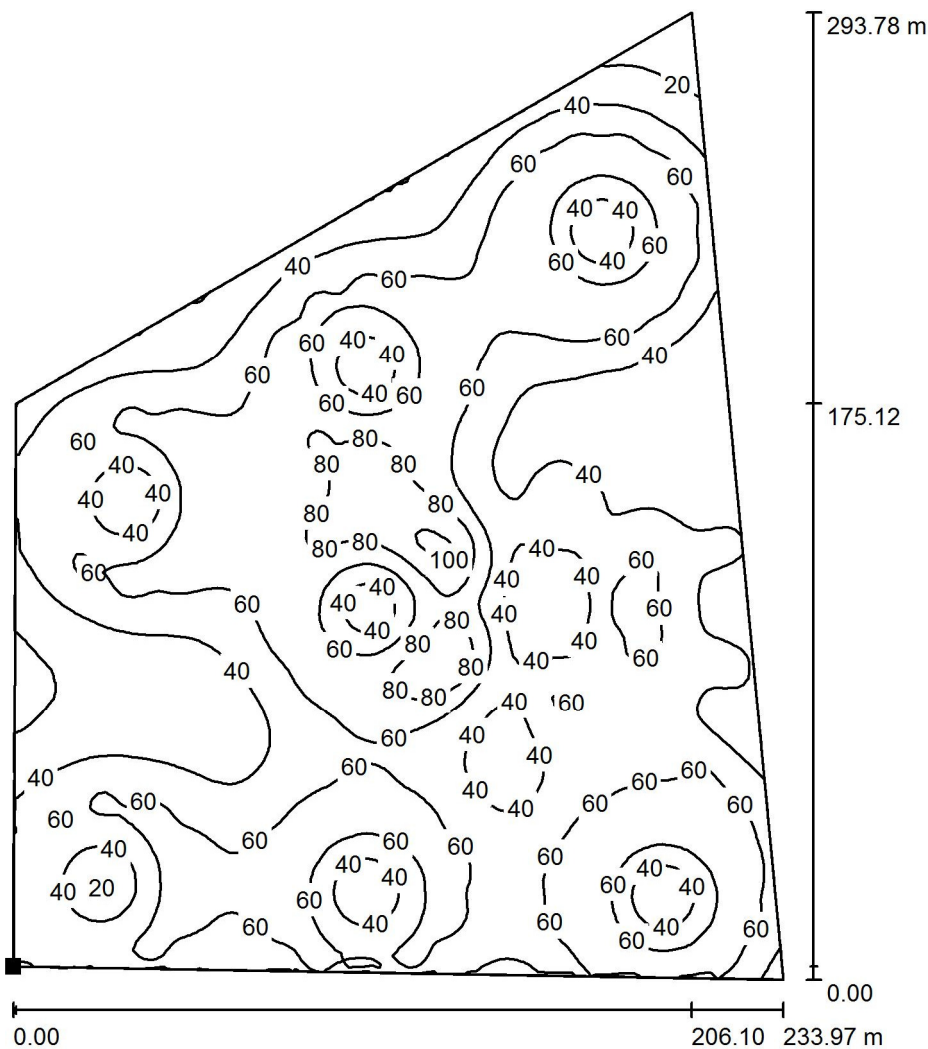

Values in Lux, Scale 1 : 2298

Position of surface in external scene:
 Marked point:
 (583.685 m, 513.592 m, 0.000 m)

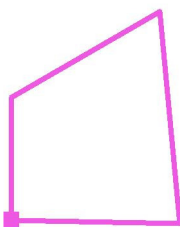

Grid: 128 x 128 Points

E_{av} [lx]
 52

E_{min} [lx]
 6.73

E_{max} [lx]
 103

u_0
 0.130

E_{min} / E_{max}
 0.065

Operator
Telephone
Fax
e-Mail

Beirut Port Area / Beirut Port Area / Surface 1 / Value Chart (E)

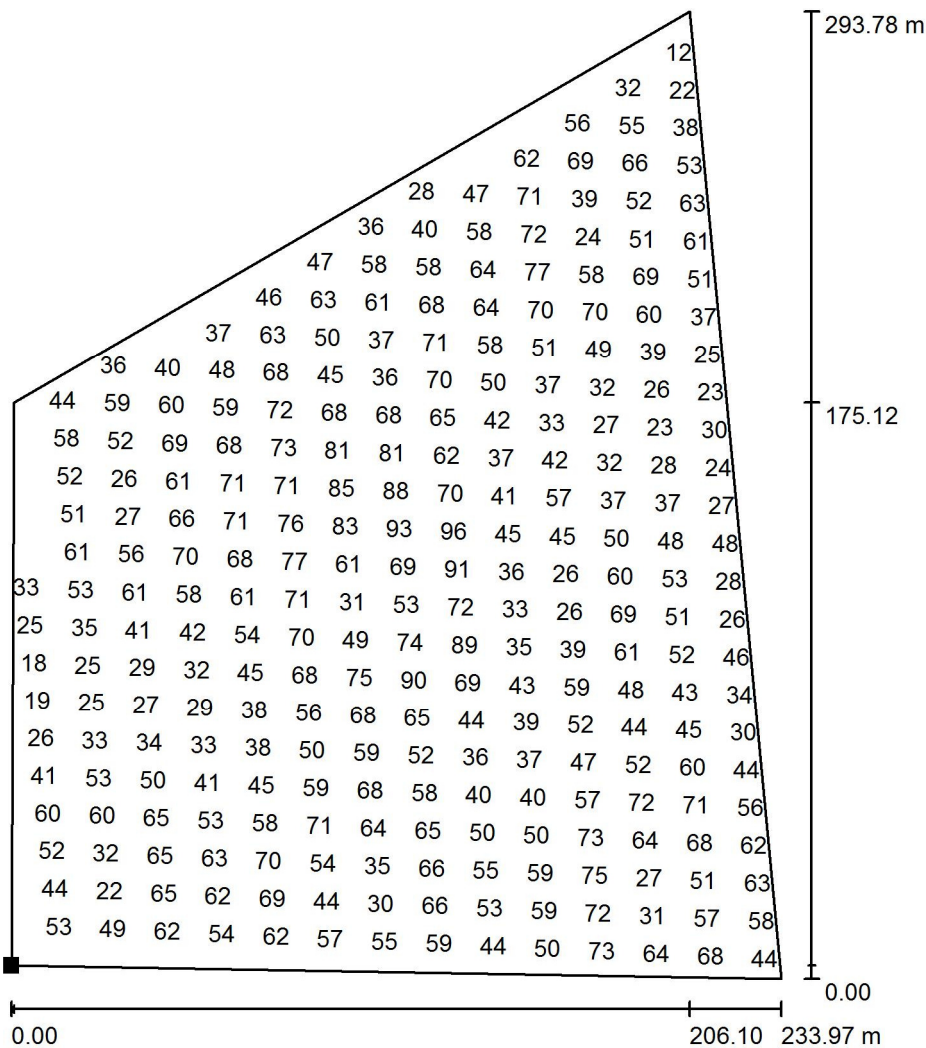

Values in Lux, Scale 1 : 2298

Not all calculated values could be displayed.

Position of surface in external scene:
Marked point:
(583.685 m, 513.592 m, 0.000 m)

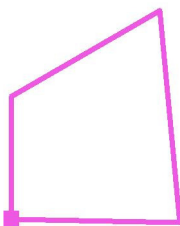

Grid: 128 x 128 Points

E_{av} [lx]
52

E_{min} [lx]
6.73

E_{max} [lx]
103

u_0
0.130

E_{min} / E_{max}
0.065